

RE-PACKING INSTRUCTIONS **DELUXE** 150N INFLATABLE PFD (VELCRO CLOSURE)

Ensure you have re-armed the PFD according to the previous instructions and all firing indicators are green.

1. Deflate the PFD by reversing the oral tube cap and pushing into the end of the oral tube.
2. Expel all air by tightly rolling up the bladder, repeat the procedure at least once to ensure all air is expelled. Replace cap in its normal position.
3. Ensure PFD is clean and completely dry.
4. Enclose Co₂ Cylinder and inflator body in protective sheath provided.
5. Lay bladder and cover on a flat surface, smooth out the bladder to remove all wrinkles.
6. Using the fold lines 1 to 4 as a guide, fold sides of bladder under and close velcro at sides ensuring pull cord is exposed once closed.
7. Velcro harness back strap in place on the cover.
8. Using fold lines 5 & 6 as a guide, fold top of bladder over and close velcro at top of cover to complete the repacking.

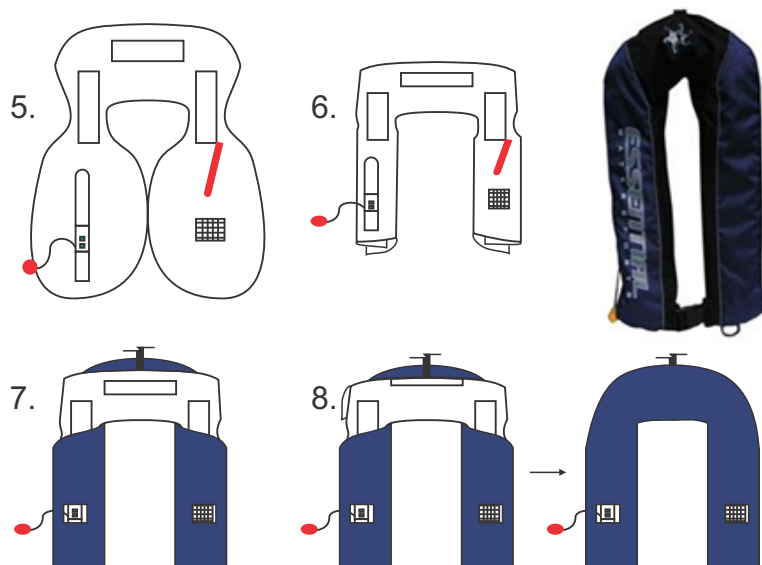

USER INFORMATION 150N INFLATABLE PFD

Please mark the service grid with date of purchase before use

Your safety will be improved if you know how to care for your PFD

PRE-WEAR CHECK

1. Visually inspect for damage.
2. Check CO₂ cylinder is full and screwed in hand tight.
3. Ensure automatic cartridge (automatic inflation models only) is screwed in hand tight.
4. Ensure once the operating head is rearmed that the indication system is showing completely green in the indication window.
5. Ensure pull cord is accessible when PFD is worn.
6. Refer to instructions for RE-ARMING the PFD if the CO₂ cylinder is empty, or any indicators are red.

CARE AND MAINTENANCE

The life of this PFD will be prolonged if routine maintenance is carried out as follows:

After every use:

Wash in warm soapy water, rinse and dry thoroughly. Store in a dry ventilated position away from direct sunlight and harmful chemicals. Remove automatic cartridge (if fitted) before washing and re-fit when dry.

Every six months:

1. Inspect CO₂ cylinder for corrosion or damage.
2. Inspect bladder for signs of abrasion and wear.
3. Inspect stitching, webbing and buckles for signs of excessive wear or abrasion.
4. Inflate bladder using the oral tube and leave overnight, inspect for any air loss or damage.
5. If there are signs of corrosion, wear, damage or leaks as described above take to a professional service agent. Never try to repair your PFD yourself.

Annually:

Carry out procedures in accordance with PFD Self Service instructions that were supplied with your PFD. PFD Self Service Instructions are also available online from bargainboatbits.com.au or scan the code below to download to your mobile device.



RE-PACKING INSTRUCTIONS 150N INFLATABLE PFD (ZIP CLOSURE)

Ensure you have re-armed the PFD according to the previous instructions and all firing indicators are green

1. Deflate the PFD by reversing the oral tube cap and pushing into the end of the oral tube.
2. Expel all air by tightly rolling up the bladder, repeat the procedure at least once to ensure all air is expelled. Replace cap in it's normal position.
3. Ensure PFD is clean and completely dry.
4. Enclose Co₂ Cylinder and inflator body in protective sheath provided.
5. Lay bladder and cover on a flat surface, smooth out the bladder to remove all wrinkles.
6. Move Zippers to velcro tab and close velcro at side ensuring pull cord placed in velcro split once closed. Using the fold lines 1 & 2 as a guide, fold left side of bladder under. Close both zippers on left side
7. Using fold lines 3 & 4 as a guide fold right side of bladder under. Then fold top of bladder over (fold lines 5 & 6) and close zip to secure bladder and complete the operation.

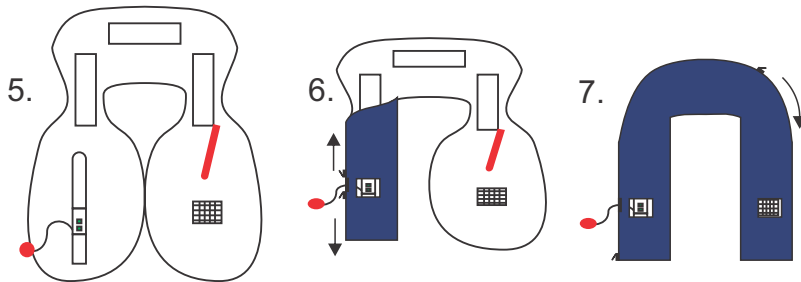

RE-PACKING INSTRUCTIONS 150N INFLATABLE PFD (COMPACT WAIST BELT)

Ensure you have re-armed the PFD according to the previous instructions and all firing indicators are green

1. Deflate the PFD by reversing the oral tube cap and pushing into the end of the oral tube.
2. Expel all air by tightly rolling up the bladder, repeat the procedure at least once to ensure all air is expelled. Replace cap in it's normal position.
3. Ensure PFD is clean and completely dry.
4. Enclose Co₂ Cylinder and inflator body in protective sheath provided.
5. Lay bladder and cover on a flat surface, smooth out the bladder to remove all wrinkles.
6. Fold the bladder in half from top to bottom and fold the oral tube down.
7. Roll the bladder up on the right side ensuring service grid is visible. Roll the left side in the same way.
8. Place the bladder back in the bag and close zipper. Ensure indicator and service grid are visible through window. Pull cord will also be enclosed. PFD must be removed from bag to operate.

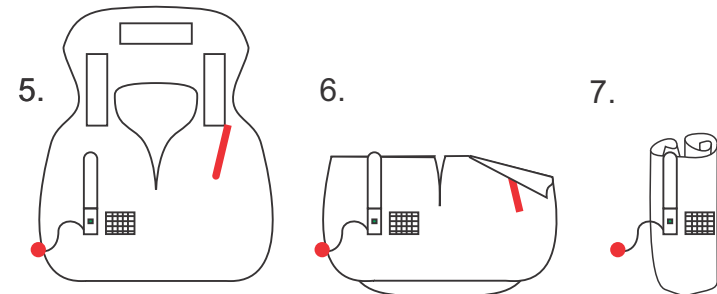

RE-ARMING INSTRUCTIONS

AUTOMATIC AS4758 150N INFLATABLE PFD

Ensure you have the both re-arm kits for the model of PFD. ULTRA AUTOMATIC AS4758 150N PFDs use 33 gram Co₂ Cylinders and Pro-Sensor automatic inflation mechanisms.

The re-arming kits will contain:

1. One 33 gram Co₂ Cylinder type and size.
2. One Pro Sensor Automatic Cartridge.

- Always refer to the PFD care and maintenance procedures in conjunction with these instructions and keep to maintenance schedule.
- PFDs should be regularly serviced by an authorised service agent.
- Re-arming kits should be kept on board for use after an emergency.



BLACK WASHER

Check that the cylinder sealing gasket in the end of the operating head has been correctly fitted, or replaced if necessary. Check the new CO₂ Cylinder has not been used and screw into the inflator body in a clockwise direction. Ensure the cylinder is screwed right down and do up hand tight.

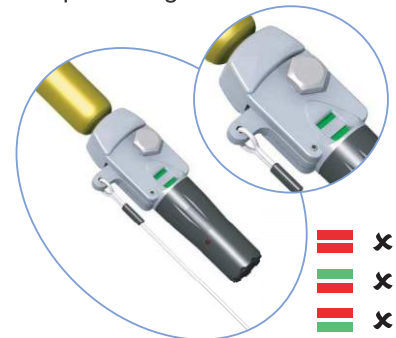

Ensure once the operating head is rearmed that the indication system is showing completely green in the indication window.



Refer to instructions to re-pack the PFD correctly.

If fired manually replace the firing arm into the unit. The arm will click into place, thereby preventing the arm from moving.

Take the new automatic cartridge and screw onto the inflator head in a clockwise direction. Screw right up ensuring there is no gap between the cartridge and inflator head and then do up hand tight.

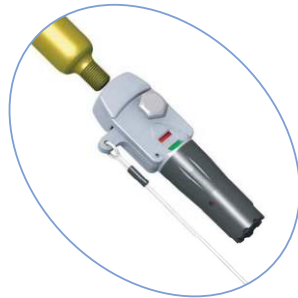

RE-ARMING INSTRUCTIONS

MANUAL AS4758 150N INFLATABLE PFD

Ensure you have the correct re-arm kit for the model of PFD. ULTRA MANUAL AS4758 150N PFDs use 33 gram Co₂ Cylinders and UML Pro-Sensor manual inflation mechanisms.

The re-arming kit will contain:

- One 33 gram Co₂ Cylinder type and size.

- Always refer to the PFD care and maintenance procedures in conjunction with these instructions and keep to maintenance schedule.
- PFDs should be regularly serviced by an authorised service agent.
- Re-arming kits should be kept on board for use after an emergency.



BLACK WASHER

Check that the cylinder sealing gasket in the end of the operating head has been correctly fitted, or replaced if necessary. Check the new CO₂ Cylinder has not been used and screw into the inflator body in a clockwise direction. Ensure the cylinder is screwed right down and do up hand tight.

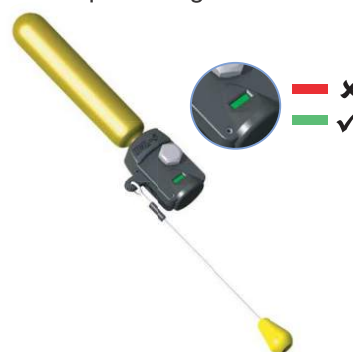

When manually fired replace the firing arm into the unit. The arm will click into place, thereby preventing the arm from moving.

Ensure once the operating head is rearmed that the indication system is showing completely green in the indication window.

Refer to instructions to re-pack the PFD correctly.